



Chesapeake Bay
Environmental Center
STEWARDSHIP & SUSTAINABILITY

2016–17 CAPITAL CAMPAIGN



NEW LAKESIDE PAVILION FOR EDUCATION | RECREATION | SPECIAL EVENTS

CBEC's exemplary environmental education programs employ a multi-disciplinary approach to learning and complement current classroom curricula. Our facilities must keep pace with increased demands, and our proposed new pavilion will provide a safe and eco-friendly space to host the more 10,000 students who come to CBEC each year . . . and much more!

But we need your help!



Chesapeake Bay Environmental Center

STEWARDSHIP & SUSTAINABILITY

The Wildfowl Trust of North America, Inc. and its physical site, the Chesapeake Bay Environmental Center, is a 501(c)3 non-profit dedicated to promoting stewardship and sustainability through environmental education and habitat restoration.



The Chesapeake Bay Environmental Center (CBEC) offers area residents and visiting eco-tourists opportunities to explore and learn about the natural world. Utilizing CBEC's beautiful 510-acre waterfront site, staff and volunteers provide exceptional environmental education programs, special events and recreational experiences for students, families, outdoor enthusiasts and organized groups.

CBEC is the perfect place for people of all ages to discover and appreciate the natural richness of the Chesapeake Bay region!

Fostering its "Conservation through Education" mission, CBEC provides:

- top-notch school programs & summer camps
- inspiring adult learning
- nature-related special events
- four miles of trails & waterfront areas for recreationists
- environmental research & habitat conservation through innovative partnerships

Hands-on Educational Programs Nature-related Recreation

Each year, CBEC provides over 30,000 hours of instruction and hands-on activities to students of all ages.

We provide a spectrum of outstanding interactive educational programs to more than 10,000 students each year, including:

- on-site field trips
- nature exploration classes for toddlers
- "Schools Out Camp" (teacher in-service days)
- 10 weeks of summer camps
- adult education

Our exemplary programs employ a multi-disciplinary approach to learning and complement current classroom curricula. Our staff and volunteers "bring to life" complex concepts in ecology, biology and environmental science by engaging students in practical and fun activities.

Trails, boardwalks and other facilities are provided to offer individuals, families and groups an array of outdoor recreational experiences, including:

- hiking
- guided/self-guided kayaking
- bird watching (over 200 species)
- nature photography
- beach/tidal pool exploration
- picnicking
- geocaching



New Pavilion Needed

As our educational programs and visitor opportunities expand, our facilities must keep pace with increased demands. The existing pavilion is the main hub for our school field trips. With fire/mold damage and needed repairs, it falls short of our quality standards.

A new pavilion will provide:

- a safe & adequate space to accommodate our school field trips
- a spot for eco-tourists to picnic, relax & restore
- a venue for special public events
- a site for club meetings & corporate retreats
- a place for celebrations & family gatherings

Front view of pavilion.



After



Lakeside view of pavilion.



After

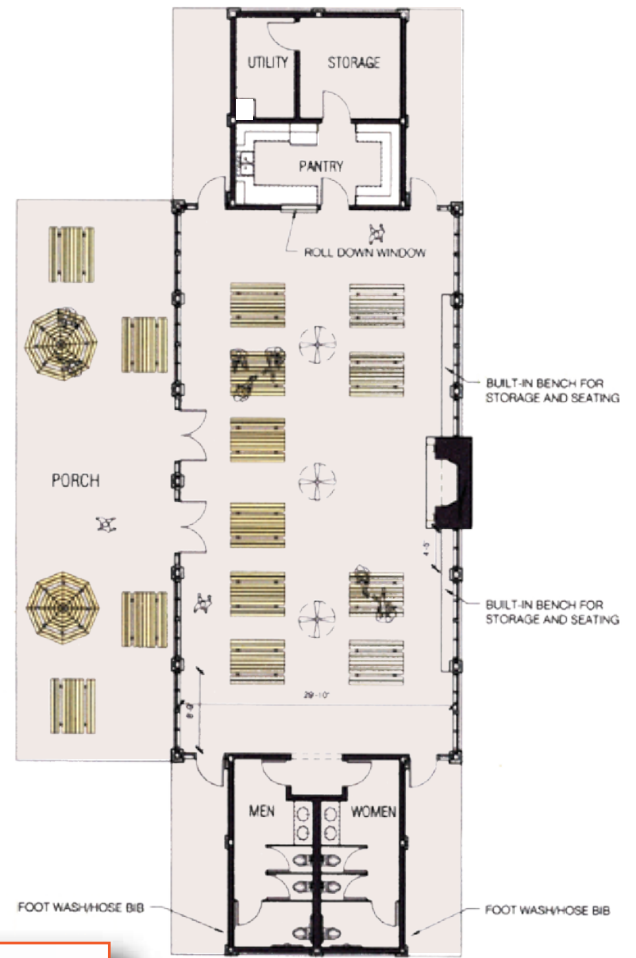

Both interior and exterior to have concrete flooring

Key Features:

- 30' x 60' teaching/event space
- fireplace & indoor/ outdoor picnic areas
- full pantry & restrooms
- a model for sustainability with "green" construction practices & products
- group rentals available

Thank you to these companies who have already pledged in-kind services and/or materials:

Steven Kahle Architects · Annapolis
Reedy Electrical Services · Ellicott City
Increte of Maryland, Inc. · Crofton



Chesapeake Bay
Environmental Center
P.O. Box 519, Grasonville, MD 21638

***Your contribution will
help us reach our goal
of \$350,000!***

CAPITAL CAMPAIGN NEW LAKESIDE PAVILION

Donor Recognition:

\$50—Listed as a donor on commemorative building plaque

\$100—Above, plus family membership

\$500—Above, plus official CBEC t-shirt

\$1,000—Above, plus two tickets to our Wet-N-Wild dinner & auction

\$5,000—Above, plus full-day use of pavilion

To make contributions and/or donate in-kind goods or services of \$10,000 and above, please contact Vicki Paulas at 410-827-6694 or email vpaulas@bayrestoration.org

(cut here & submit to above address)

Please accept my tax-deductible gift in the amount of \$ _____.

Method of payment:

☐ Enclosed check (payable to CBEC)

☐ Credit Card ☐ Visa ☐ Master Card ☐ Discover ☐ American Express

Card #: _____ Expiration Date: _____

Name on Card: _____ CW Code: _____

Signature: _____

Address: _____

City: _____ State: ____ Zip Code: _____

Phone #: _____ Email Address: _____

Organization (if applicable): _____

T-Shirt Size (if applicable): _____

CBEC is a 501(c)3 non-profit organization incorporated as the Wildfowl Trust of North America, Inc. (Federal ID # 52-1188939). Your donation is tax-deductible.

***You can donate online at:
www.bayrestoration.org/pavilioncampaign***

Designed by Fishergate, Inc.